

Forest Practices Act 1985

Forest Practices Plan

FPP No.: IAB0067-01

Certification Number: 2017-0118

Local File ID: TG018B

Update Type: Initial

Last edit by: [REDACTED]

Created on: 20/12/2016

Updated on: 08/03/2017

It is necessary to read this Forest Practices Plan in its entirety for the specifications required by Section 18(2) of the Forest Practices Act 1985. This Forest Practices Plan authorises forest practices and operations to which it refers on the land specified in the Plan and during the period specified in the Plan, provided that the operations are carried out in accordance with the Plan. This authority is given for the purposes of the Forest Practices Act 1985 only. Those carrying out the operations under the Plan should ensure that they comply with all relevant laws including the conditions of licences, permits and other authorities issued under other laws.

Coupe Name:	TG018B	Location:	Cannells Road	PTR Number:	-
Tenure:	Permanent Timber Production Zone Land	IBRA 4 region:	Woolnorth	UPI or PID Numbers:	-
District:	North West	Municipality:	Circular Head	Landowners:	Forestry Tasmania
Map Sheet:	MELLA : 3247	Grid reference:	333160mE, 5478919mN	Principal Processors:	Forestry Tasmania
Applicant:	Forestry Tasmania, 2-4 East Cam Road, Camdale Tasmania 7320, (03)64332666				

Parent Rock 1:	Cambrian Int-ly Mudstone, Siltstone & Sandstone (CIM)	Soil Description 1:	Yellowish brown mottled clayey (YMC)	Stoniness 1:	M
Parent Rock 2:		Soil Description 2:		Stoniness 2:	

Erodibility Class 1: Moderate (M) 2: [] Majority Slope: 5 deg. Maximum Altitude: 50 m

Within town water catchment:	No	Within a landscape zone in a Municipal Planning Scheme:	No
Water Intake:	-	Known Domestic Water Supply Intake within 2km:	No
Distance to Intake:	-	Net Area of Crown Land Reserve:	0.0 ha

Public Safety Risk Assessment: Not Required

Emergency meeting Point: 262 - EAST MONTAGU - JCN MONTAGU RD AND BARCOO RD

Plan certified by: [REDACTED] Date certified: 08/03/2017 Plan lifetime: 08/03/2017 - 30/06/2021 Date notice of intent sent: 24/11/2016

Discrete Operational Phase	Estimated Start Date	Estimated End Date	Details
Timber Harvesting	30/06/2017	30/06/2018	Minimum Class of Equipment to be used Dry: C1 Wet: C1 Cable: NA
Reforestation	30/06/2018	30/06/2019	
Reforestation Assessment	30/06/2019	30/06/2021	

Current RFA Forest Community and/or Land Use	Prescription	Ha
Acacia melanoxylon forest on flats (BF)	Clearfall followed by Sowing of Native Seed (CF-NF)	8.00
Tall E. obliqua forest (OT)	Clearfall followed by Sowing of Native Seed (CF-NF)	67.00
Net Operational Area: 75.00	Total Area to be Reforested: 75.00	Total Area to be Harvested: 75.00
		Total Area of Operation: 75.00

A. GENERAL

Forest Practices shall be carried out in accordance with the principles and approaches specified in the Forest Practices Code. All Forest Practices Code mandatory statements ("will" statements) apply, whether or not they are highlighted below. Other specific provisions listed in this plan are also mandatory.

- Wedge-tailed eagle breeding season (July-February inclusive) restrictions apply to this FPP Area.

B. ACCESS TO THE FOREST

(See also section D. Conservation of Natural and Cultural Values and section F. Management of Fuels, Oils, Rubbish and Emissions.)

Person or organisation assuming primary responsibility for management of forest practices under this section of the plan : **Forestry Tasmania**

- This coupe is accessed by Cannells road and Cannells spurs 1, 1-1 and 1A, all class 3 roads maintained by Forestry Tasmania.
- No machinery will be walked, or snigging carried out along roads or their verges, except when approved by a Forestry Tasmania officer. The contractor will repair damage to the roads caused by any machinery.
- Table drains will be kept clear of debris and culvert inlets and outlets are to be kept open at all times.

C. HARVESTING OF TIMBER

(See also section D. Conservation of Natural and Cultural Values and section F. Management of Fuels, Oils, Rubbish and Emissions.)

Person or organisation assuming primary responsibility for management of forest practices under this section of the plan: **Forestry Tasmania**

Up to an area of 75 ha may be harvested and reforested under this FPP.

BOUNDARIES

All operations associated with harvesting will be confined to within the boundaries as described below. (See FPP map)

- The northern boundary is part private property and this section has been marked with blue and pink flagging tape and part native forest, this section of boundary has been marked with blue flagging tape.
- The eastern boundary is in part a reserve for both *E Brookeriana* and the Keeled Snail (FIBa FaKes) and this section is marked with blue and yellow flagging tape and part native forest reserved for Long term retention (LTR) and this section is marked with blue flagging tape. A section of this boundary is also private property and this section has been marked with blue and pink flagging tape.

- The southern boundary is part Streamside Reserve (SSR) and has been marked with blue flagging tape and part Wildlife Habitat Clump (WHC) and this section is marked with blue and yellow flagging tape.
- The western boundary is part Private property and this section is marked with blue and pink flagging tape and part native forest and a constraint, these boundaries have been marked with blue flagging tape.
- Variations to the harvesting boundary alignment may be negotiated with a Forestry Tasmania officer where improvements can be made to burning boundaries, or to the ability of the contractor to efficiently harvest the coupe. Where such minor variations are agreed, the Forestry Tasmania officer will adjust the taped boundary and the action will be fully documented and signed on the District coupe file. Significant boundary relocation requires a signed variation to this plan.
- Sections of the coupe boundary adjacent to Wildlife Habitat Clumps or protected areas, as shown in yellow on the attached map, will be machine scrub rolled to approximately 3 metres width before harvesting commences in that section. Forestry Tasmania will mark the area with both blue and yellow flagging tapes.

LANDINGS

- Six (6) landings will be located on high points as indicated approximately on the attached map.
- No additional landings may be constructed or used unless authorised and documented by a Forestry Tasmania officer.
- Landings should be established by placing cording over the landing at the commencement of use.
- Bark matting will be used if it is placed on top of woody material (to prevent bark directly contacting the soil).
- Bark may be returned to the bush or heaped to the side of the landing.
- Landing site will be kept well drained so as to prevent ponding of water.
- See Landing Restoration section of this plan for additional details.

SNIG TRACKS

- Approximate snigging directions are indicated on the attached map.
- Snig tracks will be located and constructed, so as to divert water on to trackside vegetation. The tracks should be out sloped where possible.
- Cording and matting, or shovel logging techniques will be used on all major snig tracks for the period 1st July to 30th September and at other times during wet conditions. Bark matting may only be used if it is placed on top of woody material (to prevent bark directly contacting the soil).
- Cording and matting will be required on feeder tracks if rutting greater than 20 cm's occurs. Bark matting may only be used if it is placed on top of woody material (to prevent bark directly contacting the soil).
- Snig tracks shall not follow drainage depressions.

FELLING PRESCRIPTIONS (see also Conservation of Natural and Cultural Values)

- Harvesting will be by clearfelling within the boundaries on the map and marked with blue flagging tape in the field.
- Trees will be felled away from the coupe boundary unless unsafe to do so minimising slash along the coupe boundary.

- Trees should not be felled across the coupe boundary. Trees that are likely to fall across the harvesting boundary must be discussed with a Forestry Tasmania officer to determine whether they will be felled. The Contractor will ensure that tree heads are pulled back inside the harvesting boundary unless the Forestry Tasmania officer agrees they should stay. Trees that are accidentally felled across the coupe boundary are to be left in place and inspected by a Forestry Tasmania officer before deciding on a course of action.
- Where seed is required, tree heads that carry collectable amounts of mature seed capsules should be placed away from snig tracks and not disturbed after placement. The contractor should notify the Forestry Tasmania officer as soon as possible to allow collection to be carried out.
- No trees shall be felled into or out of the Wildlife Habitat Clump (WHC) or the FIBa FaKes reserve unless authorised by a Forestry Tasmania Forest Practices Officer (FPO) for safety reasons. Where a tree accidentally falls into a Wildlife Habitat Clump a decision will be made by the FPO whether the tree will be pulled out or left in place.
- No machinery shall enter the WHC or the FIBa FaKes reserve as defined with blue and yellow flagging tape.

STREAMSIDE MANAGEMENT

- No class 4 temporary stream crossings have been approved (see attached map)
- Additional stream crossings may be approved by a Forestry Tasmania officer prior to construction and usage and recorded on a monthly coupe audit. The number of temporary stream crossings is to be minimised
- If any unmapped watercourse (that does not have specific management prescriptions within the FPP) is encountered, operations will cease within 20m until advice of a Forestry Tasmania Forest Practices Officer has been received.
- Note clauses under Harvesting of Timber – Boundaries.

Streamside reserve boundaries to be marked by: **Forestry Tasmania**

How marked: **Blue flagging tape**

HARVESTING RESTORATION (by the contractor)

- Restoration will be carried out progressively as the harvesting operation progresses across the coupe, and be fully completed before a coupe clearance will be issued.

LANDINGS

- Sites will be left adequately drained as per the original ground contours.
- Cording and matting will be stripped from the landing pad and aerated before being added to heaps.
- Rubbish, metal, oil and other foreign matter will not be included in either bark or waste wood heaps.
- All heaps of landing waste (bark and waste wood) unless otherwise approved by this plan will be in accordance with Forestry Tasmania's Procedure: Bark heap management on forest product landings. Where this is not possible, alternative Fire Management options are to be approved by Forestry Tasmania.
- **Bark** will be heaped on a well drained site.

BOUNDARIES

- Pull back heaps of slash (tree heads, shrubs and other non-merchantable woody material) where they fall over the harvesting boundary.

SNIG TRACKS

- Cording shall be removed from stream crossings, allowing free flow of the stream.
- Snig track cording and matting will be lifted and aerated by the harvest contractor unless explicitly exempted by the Forestry Tasmania officer.

D. CONSERVATION OF OTHER VALUES

Prescriptions to manage flora, fauna, geomorphic, soil and water, archaeological and landscape values.

BIODIVERSITY

Prescription for the Wedge Tailed and White Bellied Sea eagle

There is a known nest associated with this operation

- To avoid nest desertion, no forestry activities (including roading, harvesting, burning and other activities such as carting, loading, boundary marking, planting, etc.) should be carried out within 500 m of the nest or within 1 km if in line of sight of the nest (August - January inclusive).
- The breeding season exclusion zone will be marked in the field with orange flagging tapes
- Contractors to notify the FPA Zoologist via the North West District eagle coordinator if any nests are discovered during the operation.
- If a nest is discovered during the breeding season (July - February inclusive) immediately cease all forestry activity within 500 m of the nest or within 1 km if in line of sight of the nest.
- If a nest is discovered outside the breeding season (March - June inclusive) cease all forestry activities within 500 m of the nest.

Prescription for the Masked Owl

- If a suspected nest or roost site is located within the operational area during operations, operations should cease within 100 m of the site and the FPA notified as soon as practical via the North West District eagle coordinator. Nests are usually located in large trees with large hollows/spouts, and may have evidence of use (e.g. pellets of regurgitated skin and bones; feathers; droppings) at the base of the tree (within the canopy drip-zone). Roost sites can be associated with similar habitat features but may also occur in understorey shrubs with dense canopies or rocky outcrops with overhangs, ledges and caves. Such sites may also show evidence of use.

Prescription for the Tasmanian Devil, Spotted Tailed and Eastern Quoll

- If a potential den site is found keep operations at least 50m away and notify FPA via the North West District planning staff.

Prescription for the Keeled Snail

- There is 2.5 hectares of Wildlife Habitat Clump set aside in the south of the coupe along with 20% of native forest within the 1 km planning unit surrounding this operation area placed into Long Term Retention (LTR).

Prescription for the Grey Goshawk

- If suspected nesting activity (e.g. displaying male birds) is observed or a nest is found, notify the FPA Zoologist (or DPIPWE specialist) via the North West District eagle coordinator and keep forestry activities at least 100m away

- **Reporting new sites for threatened fauna and flora**
- If new sites for threatened fauna (e.g., raptor nests, devil dens etc.) or flora are found during the implementation of a Forest Practices Plan, the sites must be reported to the Forest Practices Authority as soon as practical.

EARTH SCIENCES

- No specific prescriptions required.

CULTURAL HERITAGE

- No specific prescriptions required.

LANDSCAPE

- No specific prescriptions required.

APICULTURE

- The contractor is to notify Forestry Tasmania immediately if any areas that have moderate or high stocking of leatherwood trees are found in the coupe. There are to be no forestry operations within at least 10 metres of the edge of any leatherwood areas until assessed by the Forestry Tasmania supervisor.

E. ESTABLISHING FORESTS (REFORESTATION)

Person or organisation responsible for reforestation and having primary responsibility for management of forest practices under this section of the plan is: **Forestry Tasmania**

SITE PREPARATION PROCEDURES (e.g. firebreaks, access tracks, cross drains (grips), areas to be treated differently etc.)

- This coupe will be regenerated to native forest. Regeneration will be by high intensity broadcast burning and aerial sowing.
- **Procedure: Bark heap management on forest product landings.**

BURNING (e.g. Planned intensity and timing)

- Autumn High Intensity Broadcast Burn.
- Burning will be in accordance with an approved burning plan.

- The burn plan will address efforts to exclude fire from the WHC, the FLBa, FaKes reserve, the Streamside Reserve, the adjacent private property and the surrounding native forest.

SOWING or PLANTATION TREATMENTS (artificial sowing, seed zone, natural regeneration, retained growing stock, planting etc.)

- Seed collection and sowing will be in accordance with Native Forest Silviculture Technical Bulletin 1 (Forestry Tasmania 2010).
- The use of 100% on site seed for all present eucalypt species will be the desired aim. If 100% on-site seed is unattainable then aim for a minimum of 10% on-site seed. If no on-site seed is available seed will be sourced from within the same seed zone or in the absence of sufficient in-zone seed, from the nearest compatible zone.
- The seed mix should contain approximately 98% *E. Obliqua* and 2% *E. Brookeriana*.
- The seed will be aurally sown as soon as is practical (less than 21 days) following the regeneration burn.

STOCKING STANDARDS (Specify survey method and stocking standard to be achieved)

- Stocking and growth will be monitored in accordance with Native Forest Silviculture Technical Bulletin 12 (Forestry Tasmania 2011).
- If browsing animal damage has a significant effect on the establishment or early growth of the regeneration, browsing control involving shooting and/or trapping may be carried out (this will be determined by monthly browsing transect audit results and field checks by a Forestry Tasmania officer)
- A regeneration survey will be carried out at approximately one year of age as per Technical Bulletin 6 (Forestry Tasmania 2010).

Regeneration survey to be organised by: **Forestry Tasmania**

WEED CONTROL (Describe method(s) to be used)

- No specific weed control requirements for this regeneration treatment

FERTILISER APPLICATION (Describe method(s) to be used)

- No fertiliser application.

F. MANAGEMENT OF FUELS, OILS, RUBBISH AND EMISSIONS

USE OF FUEL AND LUBRICANTS

- Sites for fuel storage will be located at least 40 metres from any stream reserve and will be surrounded by an earthen bund capable of containing the maximum contents of fuel stored.
- Fuel tankers that leak fuel are not acceptable and will not be allowed on site. Care is to be taken to minimise fuel and oil spillage and waste oil is not to be tipped on the ground.
- Any fuel and oil spills greater than 20 litres will be reported to Forestry Tasmania (Ph 6433 2666) without delay.

- Any fuel or oil spills will be cleaned up and contaminated soil removed to a registered hazardous waste disposal site.

WEED MANAGEMENT

- Logging, Construction and Regeneration machinery is to be washed down prior to arriving on site as per Washdown Guidelines for Weed and Disease Control Machinery, Vehicles & Equipment Edition 1.

OTHER

- All rubbish from forestry operations will be removed.

FIRE MANAGEMENT

- The Forestry Tasmania Tactical Fire Management Plan covers this area and deals with landscape level fire management planning.

Forest Practices Officer (Planning)

Certified by (signature): [redacted] **Date:** 8-3-17

Name: [redacted]

Pursuant to a delegation from the Forest Practices Authority under section 43 of the *Forest Practices Act 1985*.

ACKNOWLEDGEMENT OF PERSONS/ORGANISATIONS IN RELATION TO THIS FOREST PRACTICES PLAN

1. Landowners consent

I am the owner of the land or the authorised agent of the owner of the land referred to in the attached Forest Practices Plan no IAB0067, (TG018B) and have given my approval for the plan to be submitted to the Forest Practices Authority for certification under section 19 of the *Forest Practices Act 1985*. I understand that, under section 25C of the *Private Forests Act 1994*, if I am a private landowner, I may be required to pay a levy to Private Forests Tasmania based on the nett area of forest operations under the plan.

Name
Company or other entity Forestry Tasmania
Address 2-4 East Cam Road
Camdale, TAS 7320
Phone
Signature
Date 03/03/2017

2. Acknowledgement of applicant

I submit the attached Forest Practices Plan no. IAB0067, (TG018B) to the Forest Practices Authority and apply for its certification. I acknowledge that I understand the provisions of the plan, and that I am responsible for ensuring that the plan is complied with unless otherwise stated in the plan. I understand that I am responsible for the lodgment of interim compliance reports with the Forest Practices Authority within 30 days of the completion of each discrete operational phase* under the plan; and further, for the lodgment of a final compliance report with the Forest Practices Authority within 30 days of the expiry of the plan. I understand that under sections 18(4A) and 18(4B) of the *Forest Practices Act 1985*, I must pay a prescribed application fee at a time, and in a manner, determined by the Authority.

Name
Company or other entity Forestry Tasmania
Address 2-4 East Cam Road
Camdale, TAS 7320
Phone
Signature
Date 03/03/2017

- *Discrete operational phases under this plan include (tick box against each forest practice proposed):
- Road construction
 - Tree fern harvesting
 - Timber harvesting
 - Forest establishment (including reforestation, i.e. restocking land with trees)
 - Assessment of reforestation
 - Tree clearing
 - Quarry operation

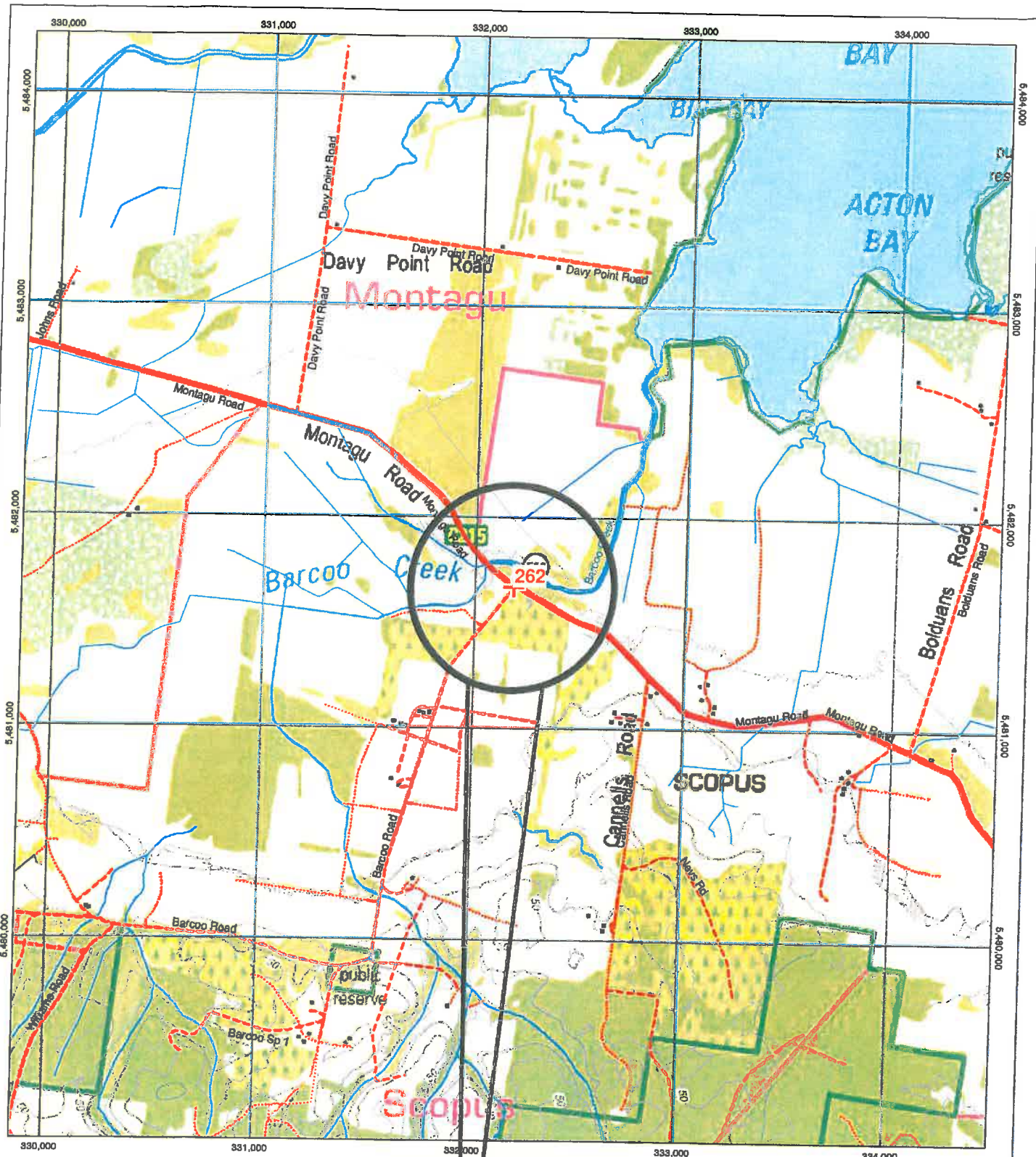

- + Emergency Meeting Points
- Not coded
- Primary all weather 2+ lane arterial road
- - - Single lane all weather minor road
- - - Single lane minor road
- Rivers, Streams & Creeks (25K)
- - - 10 Metre Contours Clipped (DIPWE)
- - - 10 Metre Contours (LIDAR)
- - - 50 Metre Contours (LIDAR)

LOCATION MAP

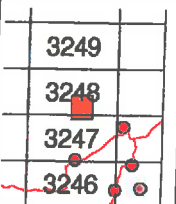

NOTE: Map co-ordinates are based on GDA94 Topographic map data is supplied by DITWE Boundaries may not co-incide due to different capture scales



Murchison Emergency Meeting Point - 262

Lat: -40° 47' 58" S, Long: 145° 00' 38" E, Coord: (332178 E, 5481669 N), 25K: (-), 100K: (7916)
 Loc. Desc: (JCN MONTAGU RD AND BARCOO RD)

Date: Tuesday, 20 December 2016
 (c) Copyright Forestry Tasmania

Prepared by: [Redacted]
 Prepared for:

Scale 1:25,000



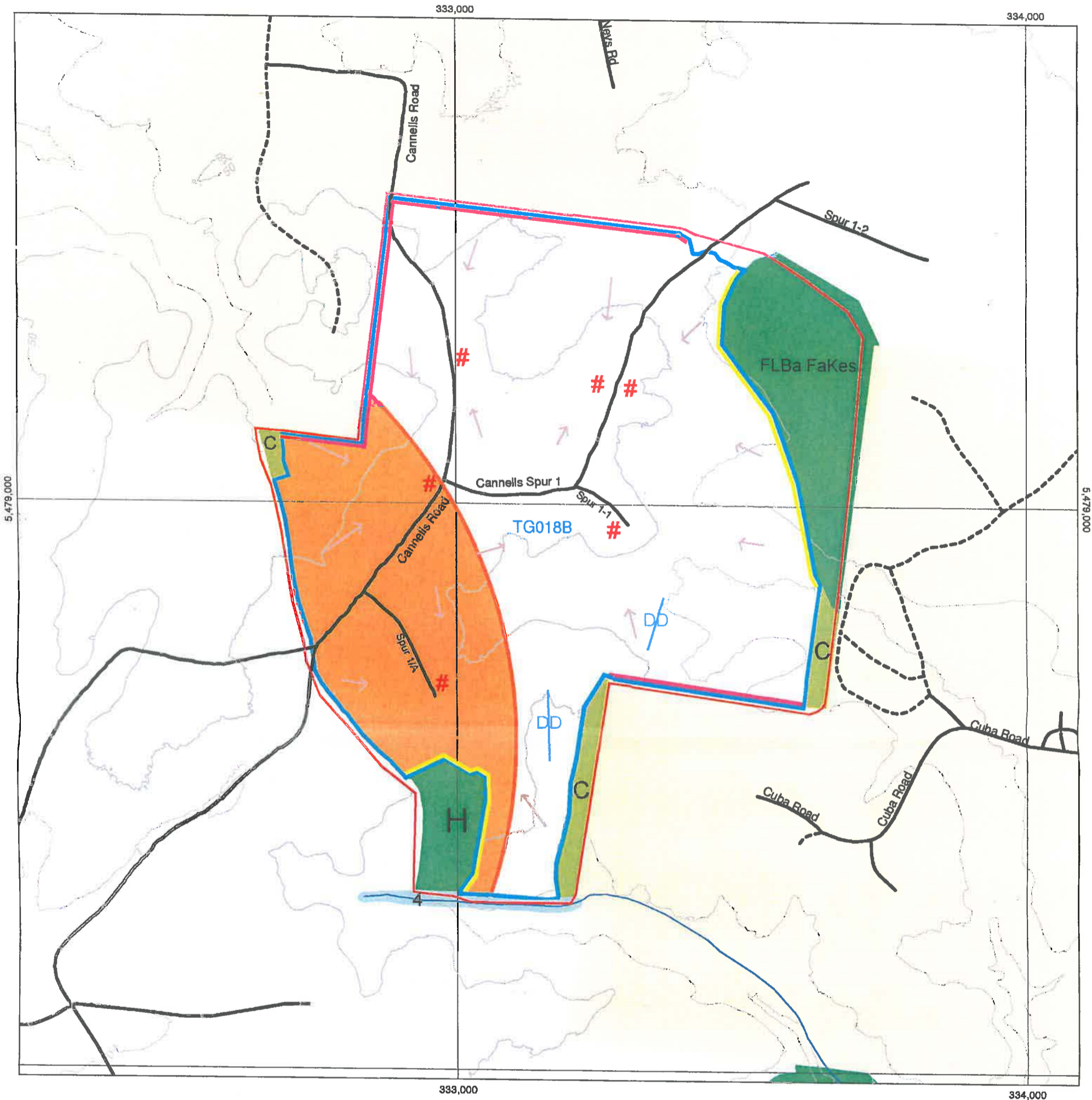

Scale 1:7300

Mapsheet: MELLA 3247

Harvest Area 75.0 hectares

A4P



LEGEND

Map Centre Coordinates: 333160 mE, 5478919 mN

- FPP boundary
- Harvest boundary
- Classed Stream
- Road class 1-3
- Road class 4
- Contours
- Snig direction
- Landing
- Private Property
- Scrubrolled Boundary
- Drainage Depression
- Private land
- LTR Constraint
- Wildlife Habitat Clump
- Streamside reserves
- Wedge Tailed Eagle breeding season exclusion zone

Date: Monday, 19 December 2016



NOTE: Map co-ordinates are based on GDA94. Topographic map data is supplied by DPIWE.

Prepared by: [Redacted]

(c) Copyright - Forestry Tasmania.