

Forest Practices Act 1985

Forest Practices Plan

FFP No.: EJL0130-01

Certification Number: 2014-0512

Local File ID: -

Update Type: Initial

Last edit by: EJL

Created on: 19/08/2014

Updated on: 21/11/2014

It is necessary to read this Forest Practices Plan in its entirety for the specifications required by Section 18(2) of the Forest Practices Act 1985. This Forest Practices Plan authorises forest practices and operations to which it refers on the land specified in the Plan and during the period specified in the Plan, provided that the operations are carried out in accordance with the Plan.

This authority is given for the purposes of the Forest Practices Act 1985 only. Those carrying out the operations under the Plan should ensure that they comply with all relevant laws including the conditions of licences, permits and other authorities issued under other laws.

Coupe Name: ST202A Location: STOODLEY PTR Number: -
 Tenure: State Forest IBRA 4 region: Woolnorth UPI or PID Numbers: -
 District: Bass Municipality: Kentish Landowners: Forestry Tasmania
 Timberlands Pacific P/L
 Map Sheet: SHEFFIELD : 4441 Grid reference: 448910mE, 5419261mN Principal Processors:
 Applicant: Forestry Tasmania, PO Box 126, Scottsdale TASMANIA 7260

Parent Rock 1: Tertiary Basalt (TBS) Soil 1: Loamy over clayey (LOC) Stoniness 1: M
 2: Quaternary Alluvial Deposits (QAD) Description 2: Sandy or Loamy over clayey (SLC) 2: L

Erodibility Class 1: Low (L) 2: Moderate (M) Majority Slope: 8 deg. Maximum Altitude: 250 m

Within town water catchment: No

Within a landscape zone in a Municipal Planning Scheme: No

Water Intake: -

Known Domestic Water Supply Intake within 2km: No

Distance to Intake: -

Net Area of Crown Land Reserve: <not defined>

Emergency meeting Point: 48 - CHINA BUSH - CNR RAILTON RD & GREAT BEND RD

Plan certified by: EJL - Date certified: 21/11/2014 Plan lifetime: 21/11/2014 - 31/08/2020 Date notice of intent sent: 11/08/2014

Discrete Operational Phase	Estimated Start Date	Estimated End Date	Details
Timber Harvesting	21/11/2014	31/08/2016	Minimum Class of Equipment to be used Dry: C1 Wet: C1 Cable: NA

Current RFA Forest Community and/or Land Use	Prescription	Ha
Plantation : E. globulus (PEG)	Clearfall followed by Softwood Plantation (CF-SP)	1.40
Net Operational Area: 1.40	Total Area to be Reforested: 1.40	Total Area to be Harvested: 1.40
		Total Area of Operation: 1.40



A. GENERAL

- Forest Practices shall be carried out in accordance with the principles and approaches specified in the Forest Practices Code. All Forest Practices Code mandatory statements (“will” statements) apply, whether or not they are highlighted below. Other specific provisions listed in this plan are also mandatory.
- The FPP map is a pictorial representation of the logging coupe. Features on the FPP map are not plotted with absolute accuracy. All features such as roads, landings, streamside reserves, stream crossings and coupe boundaries have been located on the ground prior to the operation commencing.
- Machinery is to be washed down in accordance with “**Tasmanian Washdown Guidelines for Weed and Disease Control**” prior to entering and leaving the coupe.
- Operations will not commence until the contractor is fully briefed on site by a Forestry Tasmania representative.
- The Contractor is required to have a copy of the Forest Practices Plan, and any subsequent Variations, on site during active operations.
- Operations will comply with the **Fire Prevention at Forest Operations** protocol (issued by Forest Industry Fire Management Committee), with specific attention to:
 - **Fire Fighting Equipment Required**
 - **Severe Weather Suspension of Hazardous Activities.**

B. BUILDING ACCESS TO THE FOREST (ROADING)

GENERAL

- Refer section D. CONSERVATION OF NATURAL AND CULTURAL VALUES and section F. MANAGEMENT OF FUELS, OILS, RUBBISH AND EMISSIONS for additional guidelines.

ACCESS

- Access to this coupe is via a short service spur (Forest Walk) from Sheffield Road.
- This service spur is maintained by Timberlands Pacific.
- **No additional road access to be constructed.**

MAINTENANCE

- If, during the period/s of operation, the service spur shows signs of structural damage and/or fatigue (rutting, formation damage or drainage failure etc) the contractor will contact the Forestry Tasmania representative immediately and cease carting until such time that the road has been repaired.
- The contractor is responsible for keeping table drains, culverts and trafficable grips clear and functioning at the completion of the operations or prior to leaving the area for extended periods.
- Roads will be maintained and restored to their original shape, ensuring a stable running surface and a drainage system that operates effectively. This includes all silt traps and drainage structures that are to be regularly inspected and maintained by clearing accumulated sediment.

Initials of parties to the Plan: Landowner (1)..... Date..... Applicant..... FPO.....
 Landowner (2)..... Date..... Date..... Date.....
 - 2 -

- **It is the responsibility of the contractor to cease carting when:**
 - Trucks are unable to travel under their own motive power;
 - Turbid water or mud runs in wheel ruts deeper than 100mm in the running surface of the road for a distance greater than the required culvert distance for that section of road.
- At completion of operations the road will be graded by Forestry Tasmania, if necessary, to provide a surface profile which will effectively drain the road pavement.

C. HARVESTING OR CLEARING OF TIMBER

GENERAL



- The coupe boundary will be flagged prior to operations commencing.
- The harvesting boundary will be flagged with **BLUE** tape.
- An underground water main is present and runs adjacent to the Northern boundary of this plantation. The coordinates of this water main are as follows: - From 449040E/5419260N to 448840E/5419340N.
- Machinery is not permitted to cross the Northern section of harvesting boundary. If machinery does need to cross over the Northern boundary for any reason, consideration is to be given to the exact location and the machinery is to take extra care by way of not digging/disturbing the soil.
- Machinery is permitted to cross the remaining boundaries (East, West and South) to facilitate the pushing of timber away from valuable infrastructure and adjacent vegetation back into the harvest area.
- Any movement/s outside the harvesting boundary will be kept to a minimum.
- If for any reason machinery is required to cross outside the harvesting boundary the movement will be closely monitored and it will be recorded on the harvest monitoring report form.
- Refer section D. CONSERVATION OF NATURAL AND CULTURAL VALUES of this Forest Practices Plan for additional guidelines.
- **Person or organisation assuming primary responsibility for management of forest practices under this section of the plan:** Harvesting Section - Forestry Tasmania Bass District.

FELLING PRESCRIPTION

- The felling prescription is clearfall (CLF) of (1939 age class) *E. globulus* in plantation form.
- Any tree/s that is/are identified as hazardous to the operation and/or surrounding environs will be managed as prescribed in the Forest Safety Code (Tasmania) 2007.
- Any tree/s that accidentally falls across the harvest boundary, in this case the blue line, or outside the harvest boundary will be pulled, and or pushed back into the harvest area.
- Any decisions made by the Forest Practices Officer (FPO) relative to this statement will be recorded on the Harvest Monitoring Form.
- Stump heights are to be kept as low as practically possible.

LANDING

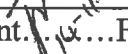
- One landing, **Landing No1** in this instance (currently used by Timberland Pacific Pty Ltd and outside the harvest boundary of this proposed operation) will be utilised for the processing of timber. The approximate location of this landing is indicated on the attached map.
- As much bark as practically possible will be returned to the harvest area.
- For additional prescriptions please refer to **page # 3 – CPR0120-01 (831202A-STOODLEY)**

Initials of parties to the Plan: Landowner (1)  Date 14-11-14 Applicant  FPO 
 Landowner (2)  Date 29/10/14 Date Date: 21-11-14

SNIGGING

- The general snigging directions are shown on the FPP map.
- For additional prescriptions please refer to page # 3 – CPR0120-01 (831202A-STOODLEY)
- **It is the responsibility of the contractor to cease logging when wet weather limitations apply as per Section C2 of the Forest Practices Code 2000.**

STREAMSIDE MANAGEMENT AND SPECIAL WATER QUALITY PROTECTION MEASURES

GENERAL

- **Streamside reserve/ boundaries to be marked by: N/A**

STREAMS/WATERBODIES

- There are no known streams within the coupe.

DRAINAGE DEPRESSIONS

- There are no known drainage depressions within the coupe.
Note: If any Streams or Drainage Depressions are identified during the period of operations, the contractor will avoid such areas until a Forestry Tasmania representative can assess the stream/Drainage Depression and make a decision in accordance with the Forest Practises Code 2000.

STREAM/WATERBODY CROSSINGS

- There is no requirement for stream/waterbody crossings within the coupe.

C1 - HARVESTING RESTORATION

LANDING

- For prescriptions applicable to this phase of operations please refer to page # 5 – CPR0120-01 (831202A-STOODLEY)
- **Please also be referred to email (Frost B – Harvest Manager, Timberlands Pacific) 18/8/2014 attached herewith.**

SNIGGING TRACKS

- Snigging tracks are to be gripped or re-contoured as per Table B, Appendix 3 of the Forest Practices Code 2000.
- Restoration of snigging tracks is to be progressive.
- If machinery movement has disturbed any natural drainage, this is to be re-directed to its original course by appropriate channelling or gripping.
- The operation is not to be left without restoration when wet weather is likely. Temporary gripping will be done:
 - Before an operation ceases due to wet weather.
 - Before shutting down for the night, weekend or holiday if wet weather is predicted.
 - Before an operation is moved from the site for any reason.
- For additional prescriptions applicable to this phase of operations please refer to page # 5 – CPR0120-01 (831202A-STOODLEY)

Initials of parties to the Plan: Landowner (1)..... Date 14/11/14 Applicant.....FPO.....
 Landowner (2)..... Date 29/10/14 DateDate: 21.11.14

ROAD

- See section **B - BUILDING ACCESS TO THE FOREST (ROADING), MAINTENANCE** of this Forest Practices Plan.

OTHER

- The contractor shall retain at least one excavator or forwarder on site until logging and restoration is completed to Forest Practises Code specifications.
- **Please also be referred to email (Frost, B – Harvest Manager, Timberlands Pacific) 18/8/2014 attached herewith.**

D - CONSERVATION OF NATURAL & CULTURAL VALUES

FLORA

Machinery washdown

- All earthmoving machinery (e.g. dozers, excavators, loaders) and forest harvesting machinery (e.g. forwarders and excavators) must be washed down prior to entering & leaving the FPP area.
- The washdown should follow the procedures detailed in the Washdown guidelines (Department of Primary Industries, Water and Environment 2004).

FAUNA

Wedge tailed eagle

Although a nest has not been found during a pre-logging search conducted on 21/5/2012, this is not a guarantee that no nests occur in the harvest area or immediately adjacent to the area. Therefore, please instruct contractors to notify the FPA via the Forest Practices Officer in charge of the operation if any nests are discovered during the operation.

If a nest is discovered during the breeding season (July - February inclusive) immediately cease all forestry activity within 500 m of the nest or within 1 km if in line of sight of the nest. The nest site will be reported to the FPA and advice on appropriate further action will be provided as soon as possible.

If a nest is discovered outside the breeding season (March - June inclusive) cease all forestry activities within 500 m of the nest. The nest site will be reported to the FPA and advice on appropriate further action will be provided as soon as possible. At this time of year in most situations the operation can resume outside the agreed 10 ha reserve boundary.

GEOSCIENCE

- No special prescriptions required.

CULTURAL HERITAGE

- No special prescriptions required.

LANDSCAPE MANAGEMENT

- No special prescriptions required.

SOIL AND WATER

- No special prescriptions required.

Initials of parties to the Plan: Landowner (1)..... Date..... Applicant..... FPO.....
 Landowner (2)..... Date..... Date

E - ESTABLISHING AND MAINTAINING THE FOREST.

GENERAL

- Refer to section **D CONSERVATION OF NATURAL AND CULTURAL VALUES** and section **F. MANAGEMENT OF FUELS, OILS, RUBBISH AND EMISSIONS**
- Person or organisation responsible for reforestation and having primary responsibility for management of forest practices under this section of the plan – **TIMBERLANDS PACIFIC.**

SITE PREPARATION PROCEDURES.

- For prescriptions applicable to this phase of operations please refer to **page # 9 – CPR0120-01 (831202A-STOODLEY)**

BURNING.

- For prescriptions applicable to this phase of operations please refer to **page # 9 – CPR0120-01 (831202A-STOODLEY)**

SOWING OR PLANTING TREATMENTS.

- N/A

WEED CONTROL.

- For prescriptions applicable to this phase of operations please refer to **page # 9 – CPR0120-01 (831202A-STOODLEY)**

FERTILISER APPLICATION.

- For prescriptions applicable to this phase of operations please refer to **page # 9 – CPR0120-01 (831202A-STOODLEY)**

RESTORATION.

- N/A

PROTECTION OF GROWING STOCK

- N/A

BROWSING.

- N/A

FIRE MANAGEMENT

- This operational area is covered by Forestry Tasmania (F.T) Bass Districts Tactical Fire Management Plan.
- Forestry Tasmania – Bass District prepares a Fire Action Plan annually that details all arrangements for fire suppression activities over the summer fire period and is inclusive of multi-agency operations.

E2. ASSESSMENT OF REFORESTATION

STOCKING STANDARDS.

- N/A

Initials of parties to the Plan: Landowner (1)..... Date..... Applicant..... FPO.....
 Landowner (2)..... Date..... Date..... Date.....
 - 6 -

F. MANAGEMENT OF FUELS, OILS, RUBBISH AND EMISSIONS

USE OF OILS, FUELS ETC



- Equipment will be maintained so that fuel leaks are minimised.
- Fuel, grease and oils will be stored in a location where any inadvertent leaks will not enter watercourses, swamps or other still waters either directly or indirectly.
- Any spills will be contained as soon as possible.
- FT Environmental Management System (EMS) Emergency Response Procedures, *Spill Control – Fuel and Oils* will be strictly adhered to.
- For prescriptions applicable to this section please refer to page # 9 – CPR0120-01 (831202A-STOODLEY)

RUBBISH

- Trade waste such as oily wastes, fuel and oil drums, filters and oily rags, wire ropes, expired mechanical parts will be regularly removed as they are generated or emptied to a collection depot suitable for receiving hazardous wastes.
- All other rubbish of a domestic nature e.g. plastic food wrappings, cordial bottles/cans, smoke packets etc., will be removed regularly to a collection depot or transfer station or recycled if appropriate.

EMISSIONS

- No special prescriptions required.

Initials of parties to the Plan: Landowner (1)  Date 14-11-14 Applicant  Date 14-11-14 FPO  Date 14-11-14
 Landowner (2) al Date 29/10/14 Date Date: 14-11-14

ST202A

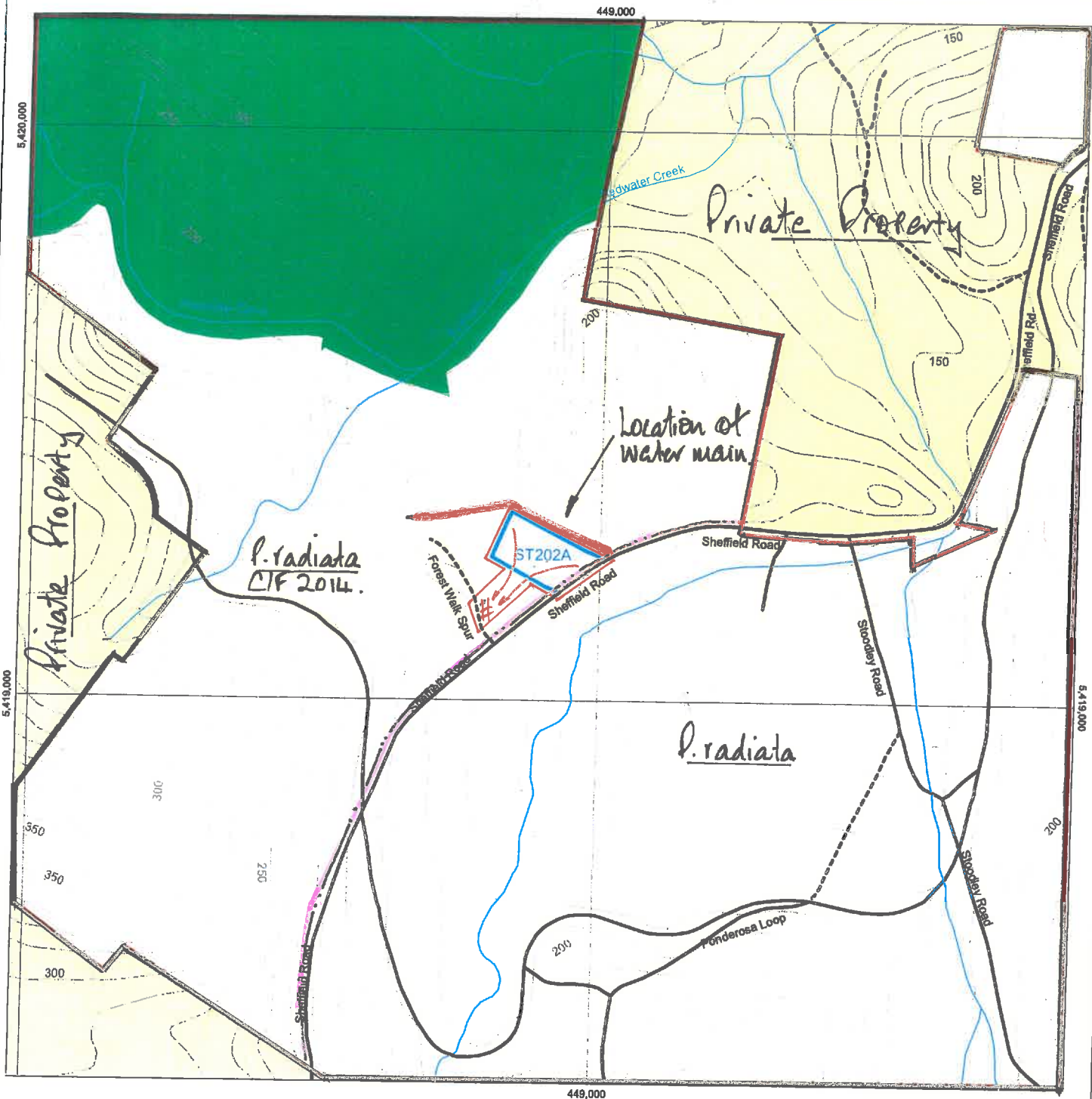

Scale 1:10,000

Mapsheets: SHEFFIELD 4441

Harvest Area 1.4 hectares

A4P



LEGEND

Map Centre Coordinates: 448910 mE, 5419261 mN

Date: Friday, 8 August 2014

- | | | | | |
|------------------|----------------------------|-----------------------|------------------------------------|------------|
| FPP boundary | Located or marked out road | Contractor boundary | Formal reserves | Constraint |
| Harvest boundary | Provisional mapped road | Landing | Informal reserves on State forest | Hazard |
| Classed Stream | Walking Tracks | Crossing | Informal reserves on other tenures | Water |
| Unclassed Stream | Hydro/Comms | Bridge | Streamside reserves | Water main |
| Road class 1-3 | Contours | Cable setting | Conditional areas | |
| Road class 4 | Snig direction | Special point feature | Private land | |



NOTE: Map co-ordinates are based on GDA94. Topographic map data is supplied by DPIWE.

Coupe: ST202A

FPP No: **FL030**

Page: 1 of 1

FPO Initials: *[Signature]*

L/O: *[Signature]*

Appl: *[Signature]*

Handwritten notes and signatures:
 Prepared by: *[Signature]*
 21.11.14
 CR 29/10/14
 11-11-14

(c) Copyright - Forestry Tasmania